



## Crank-top Mill/Grinder Fitting / Assembly Guide - CHROME MODELS 5" and 8½"

Please read this guide fully before starting your project – and please note that we try to offer guides and kits that use the minimum of equipment – we do not sell bushings or jam chucks for this kit as we consider them unnecessary.

The Prokraft crank-top mill kit is suitable for both flat woodwork and woodturning. Preparation and assembly will vary depending on the equipment to be used.

We recommend the use of 25mm and 38mm forstner or flat wood drill bits (not supplied) – these are common sized bits and will prove invaluable for many other mill kits. When using forstner bits always ensure you drill the larger holes first and reduce size as each step will leave a centre mark for the following drill.

The blank size drilling requirements are detailed below, if you are turning on a lathe you may require a longer blank to enable holding in a chuck. Estimated blank lengths as below:

5" = 112mm

8½" = 200mm

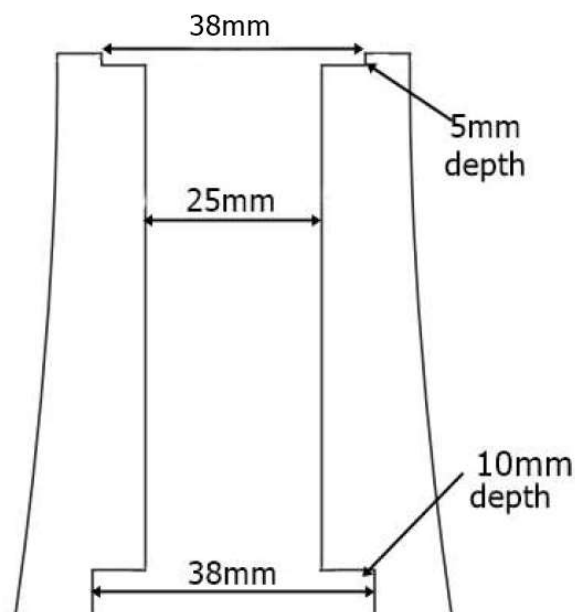

The mill should be assembled as in the diagram below, please note the top plate is metal and is secured with the longer screws, the bottom plate is plastic and is secured with the shorter screws.

Ensure you drill adequate pilot holes for the screws, failure to do so may cause screws to break, we recommend 1.5mm pilot holes and the use of a P1 head screwdriver.

For ease of assembly we recommend fitting the shaft and all the bottom components first which secures most of the kit in place and makes fitting the head plate easier.

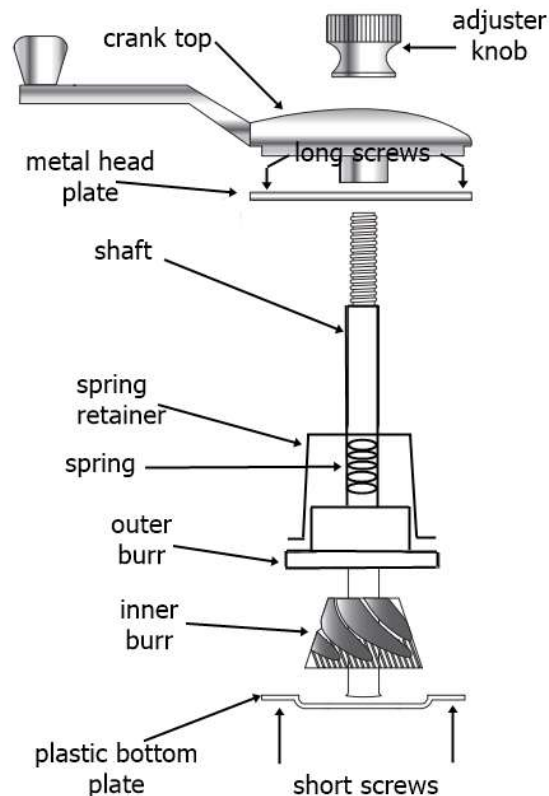

DO NOT fully tighten the adjuster knob and force the handle or you may damage the grinder burrs.

If you are making a pair for salt & pepper try using different coloured woods or marking your blank to differentiate between the contents.

Finally, we hope you enjoy the kit and as long as handled carefully & correctly if you make an error it can be dis-assembled and re-used in another blank.